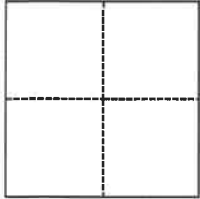

CORNER RECORD

Agency Index BK 140 PG 95Document Number CR 15526City of Oakland (APN 32-2030-151) County of Alameda, California
Brief Legal Description Monument at Suter Street and Loma Vista Way, near 3630 Suter Street.**CORNER TYPE**

☐ Government Corner ☒ Control
☐ Meander ☐ Property
☐ Rancho ☐ Other

Date of Survey June 7, 2021**COORDINATES (Optional)**

N. _____ E. _____

Elevation _____

Units ☐ Metric ☒ U.S. Survey Foot

Horizontal Datum _____

Zone _____ Epoch Date _____

Vertical Datum _____

☐ Complies with Public Resources Code §§8801-8819☐ Complies with Public Resources Code §§8890-8902PLS Act Ref.: ☐ 8765(d) ☒ 8771 ☐ 8773 ☐ Other:

Corner/
Monument: ☒ Left as found ☐ Established ☐ Rebuilt ☒ Pre-Construction
☐ Found and tagged ☐ Reestablished ☒ Referenced ☐ Post-Construction

Narrative of corner identified and monument as found, set, reset, replaced, or removed:

☒ See sheet #2 for description(s):

Found monument that could be damaged or destroyed by planned water line construction project. Monument was referenced per CR 15191; as shown on page 2. The purpose of this Corner Record is to preserve possible evidence only; no attempt was made to determine the relationship to property, centerline, or right of way lines.

Reference EBMUD CR Book B, Page 120 (Taanning/Chou)

SURVEYOR'S STATEMENT

This Corner Record was prepared by me or under my direction in conformance with

the Professional Land Surveyors' Act on September 9, 2021Signed [Signature] P.L.S. or R.C.E. No. 8889**COUNTY SURVEYOR'S STATEMENT**

This Corner Record was received

SEP 14 2021

and examined and filed

Signed D. Ian Wilson P.L.S. or R.C.E. No. 7010Title ALAMEDA COUNTY SURVEYOR

County Surveyor's Comment

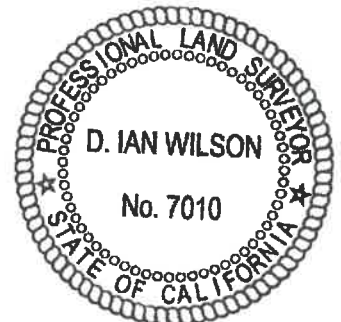

OAKLAND

ALAMEDA COUNTY

VALLEY VIEW TRACT

23 M 44

BLOCK E

3630 SUTER STREET

APN 32-2030-151

SUTER STREET

LOMA VISTA WAY

[100.59']
0.3' EDGE OF
DWY OF #3631

28.35'
(28.35')

[100.00']

19.79'

6.3' S OF
WATER VALVE

26.50'

10.8' N.
OF FH

38.48'

15.7' SE OF JP

23 M 44
BLOCK D

O'ROURKE TRACT

1 M 64

LEGEND

FOUND 1/4" PIN IN CONCRETE, DOWN 1' IN STANDARD MONUMENT WELL



FOUND CONCRETE ANCHOR NAIL WITH 1-1/2" ALUMINUM WASHER STAMPED
"EBMUD MON RP" IN TOP OF CURB PER CR 15191



SET CONCRETE ANCHOR NAIL WITH 1-1/2" ALUMINUM WASHER STAMPED
"EBMUD MON RP" IN TOP OF CURB

[]

ELEVATION (MEASURED USING A LEICA DIGITAL LEVEL) PER CR 15191

()

RP DISTANCED PER CR 15191



SCALE
1"=20'



ADDRESS: 3630 SUTER STREET

APN: 32-2030-151