

OWNERS' CERTIFICATE

THOMAS H. LOWE AND MARY H. LOWE, TRUSTEES, OF THE UDT DATED 4-6-87 HEREBY CERTIFY THAT THEY ARE THE OWNERS OF THE LAND DELINEATED AND EMBRACED WITHIN THE EXTERIOR BOUNDARY LINES ON THE HEREIN EMBODIED MAP ENTITLED "TRACT 6348 CITY OF OAKLAND, ALAMEDA COUNTY, CALIFORNIA"; THAT THEY ARE THE OWNERS OF SAID LAND BY VIRTUE OF THE GRANT DEED RECORDED JULY 7, 1993 SERIES NUMBER 93-242383, RECORDS OF ALAMEDA COUNTY, CALIFORNIA, AND; THAT THEY CONSENT TO THE PREPARATION AND RECORDATION OF THIS MAP.

THOMAS H. LOWE AND MARY H. LOWE, TRUSTEES OF THE UDT DATED 4-6-87:

THOMAS H. LOWE
TRUSTEE

MARY H. LOWE
TRUSTEE

ADDRESS OF OWNER:
2975 ROHRER DRIVE
LAFAYETTE, CA. 94549

OWNERS ACKNOWLEDGEMENT

STATE OF CALIFORNIA
COUNTY OF CONTRA COSTA

ON FEBRUARY 14, 2000, BEFORE

ME, ELIZABETH A. MALONE A
NOTARY PUBLIC IN AND FOR SAID COUNTY AND
STATE PERSONALLY APPEARED

THOMAS H. LOWE and MARY H. LOWE

PERSONALLY KNOWN TO ME (OR PROVED TO ME) ON THE BASIS OF SATISFACTORY EVIDENCE, TO BE THE PERSONS WHO NAMES ARE SUBSCRIBED TO THE WITHIN STATEMENT AND ACKNOWLEDGED TO ME THAT THEY EXECUTED THE SAME IN THEIR AUTHORIZED CAPACITIES, AND THAT BY THEIR SIGNATURES ON THE STATEMENT THE PERSONS OR THE ENTITY UPON BEHALF OF WHICH THE PERSONS ACTED, EXECUTED THE STATEMENT.

WITNESS MY HAND

SIGNED Elizabeth A. Malone

PRINTED NAME ELIZABETH A. MALONE

MY COMMISSION EXPIRES: 7/4/00

PRINCIPAL PLACE OF BUSINESS: 1021 BROWN AVE.
LAFAYETTE, CA
94549

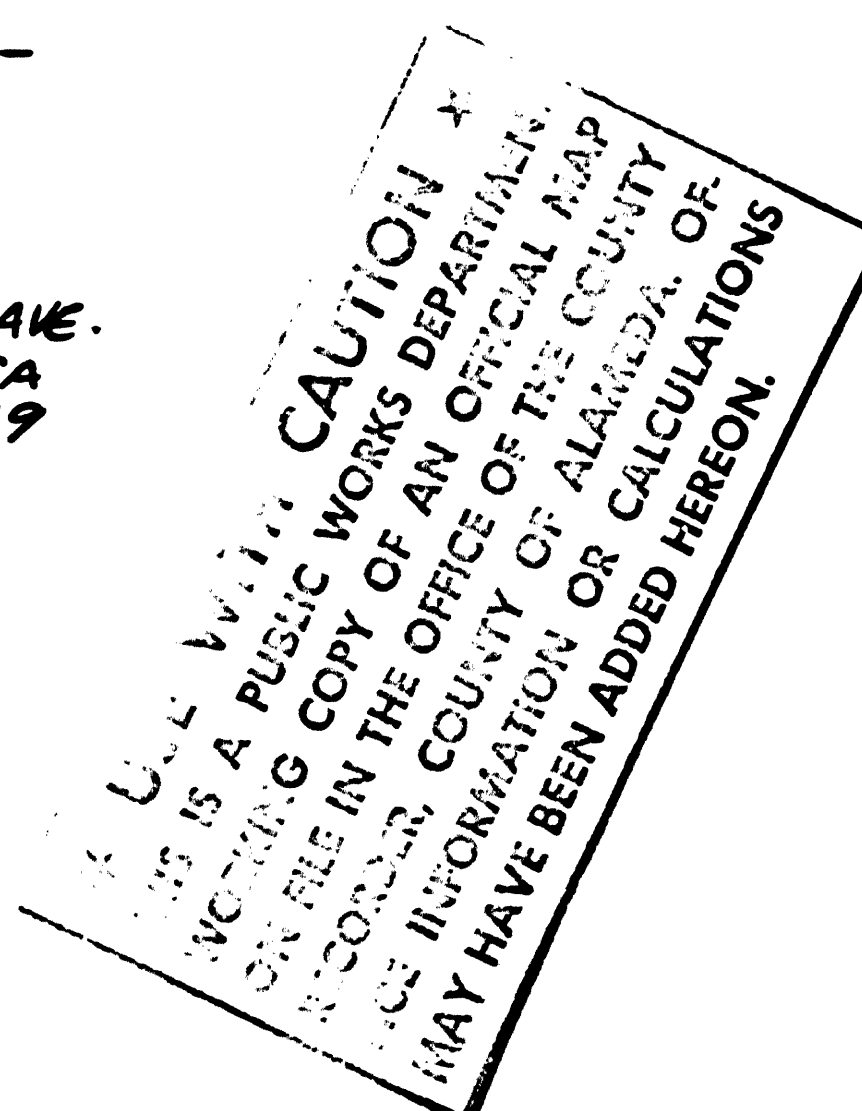

CITY ENGINEER'S CERTIFICATE

I, CALVIN N. WONG, DIRECTOR OF BUILDING SERVICES, HAVING BEEN AUTHORIZED TO PERFORM THE FUNCTIONS OF THE CITY ENGINEER OF THE CITY OF OAKLAND, COUNTY OF ALAMEDA, STATE OF CALIFORNIA, FOR THE PURPOSES OF REVIEWING SUBDIVISION MAPS, DO HEREBY CERTIFY THAT I HAVE EXAMINED THE HEREON EMBODIED FINAL MAP ENTITLED "TRACT 6348 CITY OF OAKLAND, ALAMEDA COUNTY, CALIFORNIA"; THAT THE SUBDIVISION SHOWN UPON SAID FINAL MAP IS SUBSTANTIALLY THE SAME AS THAT APPEARING ON THE APPROVED TENTATIVE MAP AND ANY APPROVED ALTERATIONS THEREOF; THAT SAID FINAL MAP COMPLIES WITH ALL PROVISIONS OF THE SUBDIVISION MAP ACT OF THE GOVERNMENT CODE AND THE LOCAL ORDINANCE APPLICABLE AT THE TIME OF APPROVAL OF THE TENTATIVE MAP; AND THAT I AM SATISFIED THAT THE FINAL MAP IS TECHNICALLY CORRECT.

DATE: 2-15-00

Calvin N. Wong
CALVIN N. WONG, RCE 25773
EXPIRES 12-31-2001
DIRECTOR OF BUILDING SERVICES
CITY OF OAKLAND, COUNTY OF ALAMEDA
STATE OF CALIFORNIA

CERTIFICATE OF SECRETARY OF PLANNING COMMISSION

I, CHARLES S. BRYANT, SECRETARY OF THE CITY PLANNING COMMISSION OF THE CITY OF OAKLAND, STATE OF CALIFORNIA, DO HEREBY CERTIFY THAT THE TENTATIVE MAP OF THE HEREON EMBODIED FINAL MAP ENTITLED "TRACT 6348 CITY OF OAKLAND, ALAMEDA COUNTY, CALIFORNIA" WAS PRESENTED TO THE CITY PLANNING COMMISSION AS PROVIDED BY THE SUBDIVISION MAP ACT AT A REGULARLY SCHEDULED MEETING ON APRIL 17, 1991, AND THAT SAID COMMISSION APPROVED SAID TENTATIVE MAP UPON WHICH THIS MAP WAS BASED.

DATE: 2/15/00

Charles S. Bryant
CHARLES S. BRYANT, SECRETARY OF THE
PLANNING COMMISSION OF THE CITY OF
OAKLAND, STATE OF CALIFORNIA

CERTIFICATE OF CLERK, BOARD OF SUPERVISORS

I, CRYSTAL K. HISHIDA, CLERK OF THE BOARD OF SUPERVISORS OF THE COUNTY OF ALAMEDA, STATE OF CALIFORNIA, HEREBY STATE, AS CHECKED BELOW THAT:

☒ AN APPROVED BOND HAS BEEN FILED WITH THE SUPERVISORS OF SAID COUNTY AND STATE BOARD IN THE AMOUNT OF \$4029.00, CONDITIONED FOR PAYMENT OF ALL TAXES AND SPECIAL ASSESSMENTS COLLECTED FOR PAYMENT OF TAXES WHICH ARE NOW A LIEN AGAINST THE LAND EMBRACED WITHIN THE EXTERIOR BOUNDARY LINES UPON THE HEREIN EMBODIED FINAL MAP OR ANY PORTION THEREOF BUT NOT YET PAYABLE.

☐ ALL TAXES AND SPECIAL ASSESSMENTS COLLECTED AS TAXES HAVE BEEN PAID AS CERTIFIED BY THE TREASURER, TAX COLLECTOR OF ALAMEDA COUNTY.

IN WITNESS WHEREOF, I HEREUNTO SET MY HAND
THIS 17th DAY OF March, 1999:
2000

CRYSTAL K. HISHIDA

CLERK OF THE BOARD OF SUPERVISORS OF THE
COUNTY OF ALAMEDA, STATE OF CALIFORNIA

BY: A. Ladd
DEPUTY CLERK

TRACT 6348

PORTION OF THE RANCHO SAN ANTONIO (ANTONIO MARIA PERALTA, ET. AL)

CITY OF OAKLAND ALAMEDA COUNTY, CALIFORNIA

HUMANN COMPANY
1021 BROWN AVENUE
PHONE: 925-283-5000

CIVIL ENGINEERING LAND SURVEYING
LAFAYETTE, CALIFORNIA
FAX: 925-283-3578

SCALE: 1" = 30'

FEBRUARY, 1999

SURVEYOR'S CERTIFICATE

I, ERIC A. HUMANN, HEREBY CERTIFY THAT THE SUBDIVISION SHOWN ON THIS MAP WAS PREPARED BY ME OR UNDER MY DIRECTION AND IS BASED UPON A TRUE AND COMPLETE SURVEY MADE IN THE FIELD UNDER MY DIRECTION IN FEBRUARY, 1999; THAT THE MONUMENTS SHOWN HEREON ARE OF THE CHARACTER AND OCCUPY SUCH POSITIONS AS SHOWN HEREON, AND THAT SAID MONUMENTS WILL SUFFICIENT TO ENABLE THE SURVEY TO BE RETRACED.

Eric A. Humann
ERIC (RICK) A. HUMANN PLS 5452
EXPIRES 9-30-2000

DATE: 2-14-00

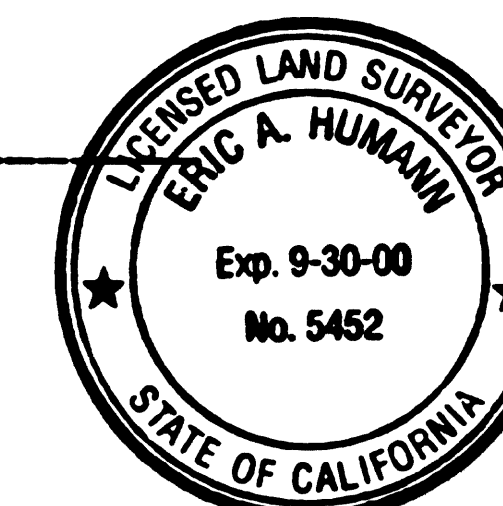

CITY CLERK'S CERTIFICATE

I, CEDA FLOYD, CITY CLERK AND CLERK OF THE COUNCIL OF THE CITY OF OAKLAND, STATE OF CALIFORNIA, DO HEREBY CERTIFY THAT THE HEREIN EMBODIED MAP ENTITLED "TRACT 6348 CITY OF OAKLAND, ALAMEDA COUNTY, CALIFORNIA" WAS PRESENTED TO THE CITY COUNCIL OF THE CITY OF OAKLAND, AT A REGULAR MEETING THEREOF, HELD ON THE 15 DAY OF February, 2000, AND THAT SAID COUNCIL DID AT SAID REGULAR MEETING BY RESOLUTION NO. 2522 CMS APPROVE SAID MAP.

DATE: 2-22-00
Ceda Floyd
CEDA FLOYD, CITY CLERK OF THE
COUNCIL OF THE CITY OF OAKLAND,
COUNTY OF ALAMEDA, STATE OF
CALIFORNIA

RECORDER'S CERTIFICATE

FILED THIS 23rd DAY OF March
2000 AT 8:30 A.M. IN BOOK 250
OF MAPS OF AT PAGES 66-67 AT THE REQUEST
OF Fidelity National Title Co.
Series #2000084801

PATRICK O. CONNELL
COUNTY RECORDER

BY: Marie M. Tatum
DEPUTY COUNTY RECORDER

A.P. No: 29-1151-055 SHEET 1 OF 2

TRACT 6348
99-99/952

MAP BK 250

AP 66-67

99006
BK 250 Pg 66

APR 10 2000

FILED 3-23-00

397

FOR REDUCED ENGLISH PLANS
ORIGINAL SCALE IS IN INCHES
FOR REDUCED METRIC PLANS
ORIGINAL SCALE IS IN METERS

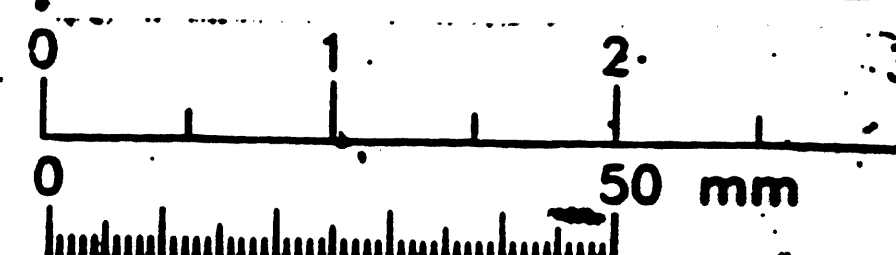

66